



Chellow Grange, Chellow Lane, Bradford, BD9

- **DEPOSIT FREE OPTIONS AVAILABLE**
- IDEAL FOR PROFESSIONALS OR COUPLES
- AVAILABLE: NOW
- DOUBLE GLAZING AND CENTRAL HEATING
- EPC RATING- C
- STUDIO APARTMENT
- UNFURNISHED
- COMMUNAL GARDEN
- COUNCIL TAX BAND- A
- LOCAL AMENITIES, SCHOOL AND TRANSPORT LINKS WITHIN THE AREA

£700 Per Month - Deposit £807 - ** Deposit Free option Available **



Chellow Grange, Chellow Lane, Bradford, BD9

DESCRIPTION

Available to let, this well-presented studio which offers modern and convenient living in good condition. Ideally situated in an area boasting excellent public transport links and a wealth of local amenities, this property provides easy access to everything you may need for daily life, as well as nearby green spaces for relaxation and recreation.

The flat features a spacious double bedroom offering comfortable accommodation, and a modern bathroom designed for practicality and ease of use. The kitchen is thoughtfully laid out with ample storage and workspace, making it ideal for those who enjoy preparing meals at home.

Residents can take advantage of a sizeable communal garden, perfect for unwinding after work or socialising with neighbours. The property benefits from an EPC rating of C and is within council tax band A, providing efficiency and affordability.

With its combination of quality condition, contemporary living spaces, and superb location, this studio is ideally suited to professionals and couples seeking a stylish and convenient home. The abundance of nearby shops, cafes, and parks, along with easy access to transport, ensures a comfortable and well-connected lifestyle.

Early viewing is highly recommended in order to appreciate the full appeal of this property. Enquire today to arrange your appointment or for further information about making this sought-after studio your next home.

**** Flatfair's No Deposit solution ****

**** This property is available with flatfair's No Deposit solution, so you won't have to pay a traditional deposit. Instead, you would pay a small check-in fee equal to 28% of a month's rent (+VAT) – significantly less than a five week deposit. This fee is non-refundable and is not a deposit so cannot be used towards covering the cost of any future damages that might occur.****





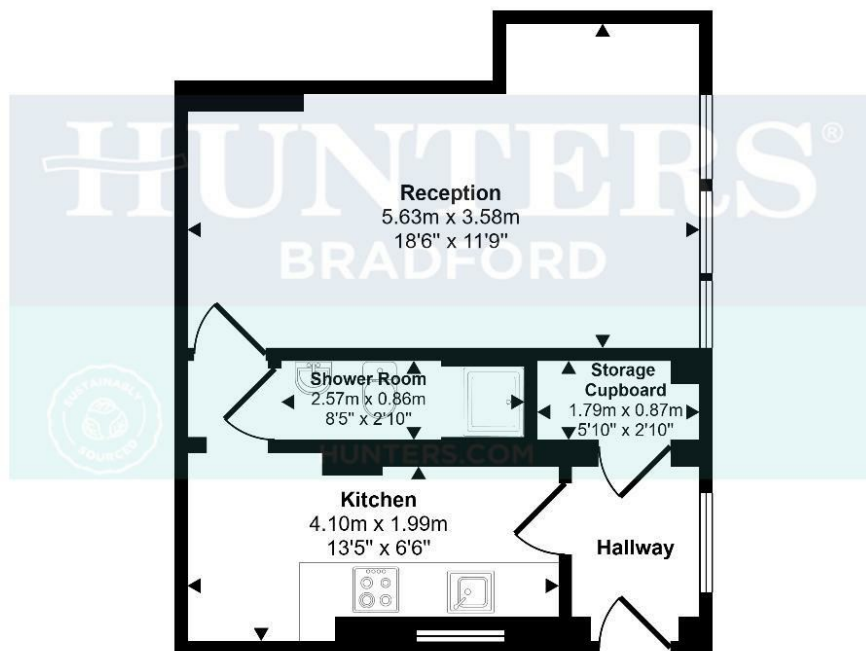

Floorplan

This floorplan is only for illustrative purposes and is not to scale. Measurements of rooms, doors, windows, and any items are approximate and no responsibility is taken for any error, omission or mis-statement. Icons of items such as bathroom suites are representations only and may not look like the real items. Made with Made Snappy 360.

Viewings

Please contact bradford.lettings@hunters.com, if you wish to arrange a viewing appointment for this property or require further information.

Valuations

For a valuation of your property, please email the team with your property details, contact information and the times you are available.

ENERGY PERFORMANCE CERTIFICATE

The energy efficiency rating is a measure of the overall efficacy of a home. The higher the rating the more energy efficient the home is and the lower the fuel bills will be.

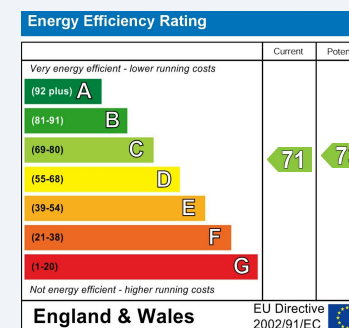

These particulars are intended to give a fair and reliable description of the property but no responsibility for any inaccuracy or error can be accepted and do not constitute an offer or contract. We have not tested any services or appliances (including central heating if fitted) referred to in these particulars and the purchasers are advised to satisfy themselves as to the working order and condition. If a property is unoccupied at any time there may be reconnection charges for any switched off/disconnected or drained services or appliances - All measurements are approximate.

THINKING OF SELLING? If you are thinking of selling your home or just curious to discover the value of your property, Hunters would be pleased to provide free, no obligation sales and marketing advice. Even if your home is outside the area covered by our local offices we can arrange a Market Appraisal through our national network of Hunters estate agents.